

jem
DEVELOPMENT COMPANY
 405 E YAKIMA AVENUE
 YAKIMA, WASHINGTON 98901
 (509) 248-1000

Copyright © 2004 by Jem Development Company. All rights reserved. No part of this work may be reproduced or transmitted in any form or by any means, including photocopying and recording, or by any information storage or retrieval system, except as may be permitted in writing by Jem Development Company, Inc.

RETAIL SPACE
 FOR
 YAKIMA, WA

DATE: APR 29, 2004
 JOB NO:
 SCALE: 1"=30'
 SHEET NUMBER: UL

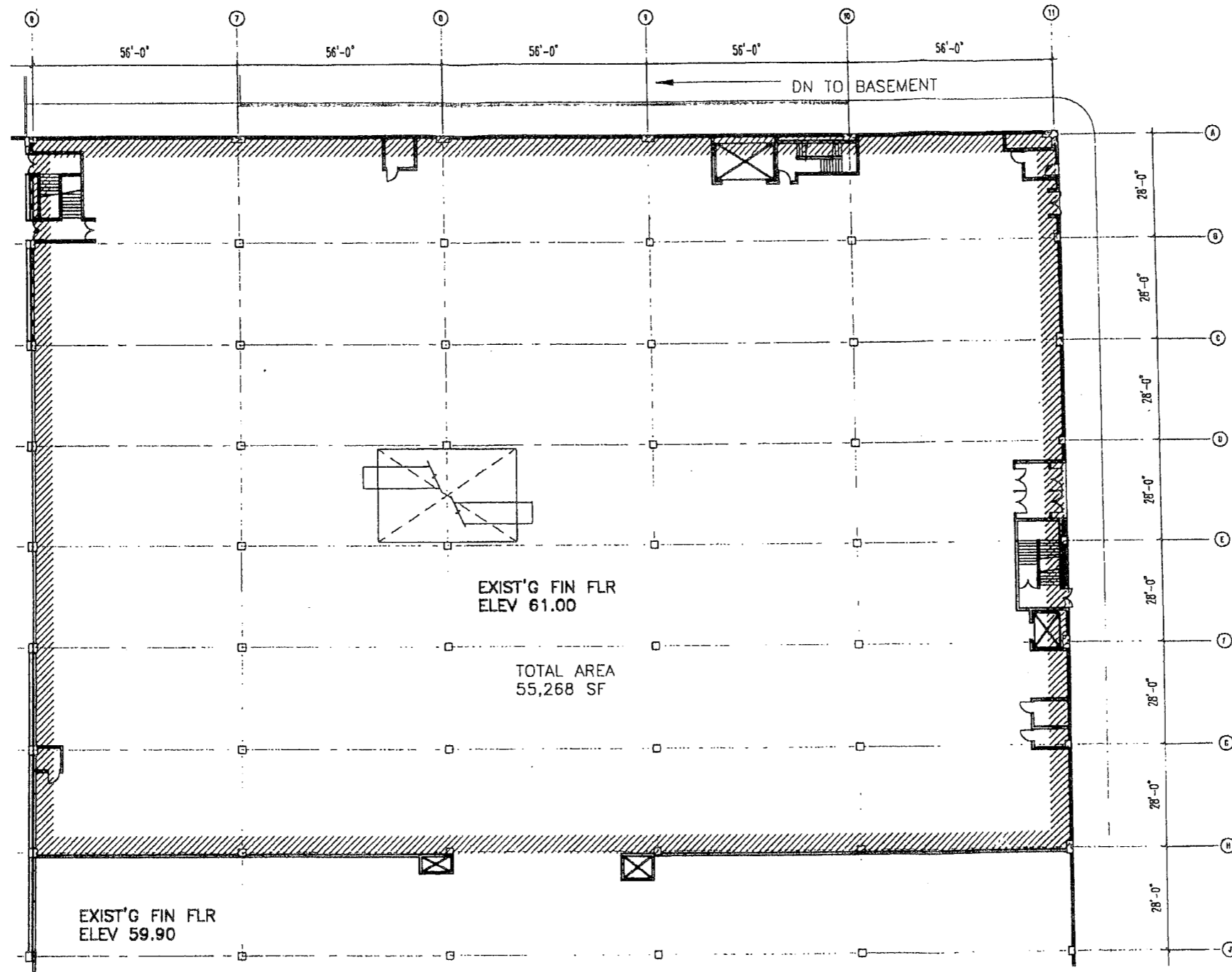

EXIST'G FIN FLR
ELEV 61.00

TOTAL AREA
55,268 SF

EXIST'G FIN FLR
ELEV 59.90

DN TO BASEMENT

MAIN LEVEL

jem
DEVELOPMENT COMPANY
402 E. YAKIMA AVENUE
YAKIMA, WASHINGTON, 98901
(509) 248-4040

ALL RIGHTS RESERVED. NO PART OF THIS WORK MAY BE REPRODUCED OR TRANSMITTED IN ANY FORM OR BY ANY MEANS, ELECTRONIC OR MECHANICAL, INCLUDING PHOTOCOPYING, RECORDING, OR BY ANY INFORMATION STORAGE OR RETRIEVAL SYSTEM EXCEPT AS MAY BE PERMITTED BY THE 1976 COPYRIGHT LAW IN WRITING BY JEM DEVELOPMENT COMPANY, INC.

RETAIL SPACE
FOR
YAKIMA, WA

DATE: APR 29, 2004
JOB NO.
SCALE: 1" = 20'
SHEET NUMBER: ML

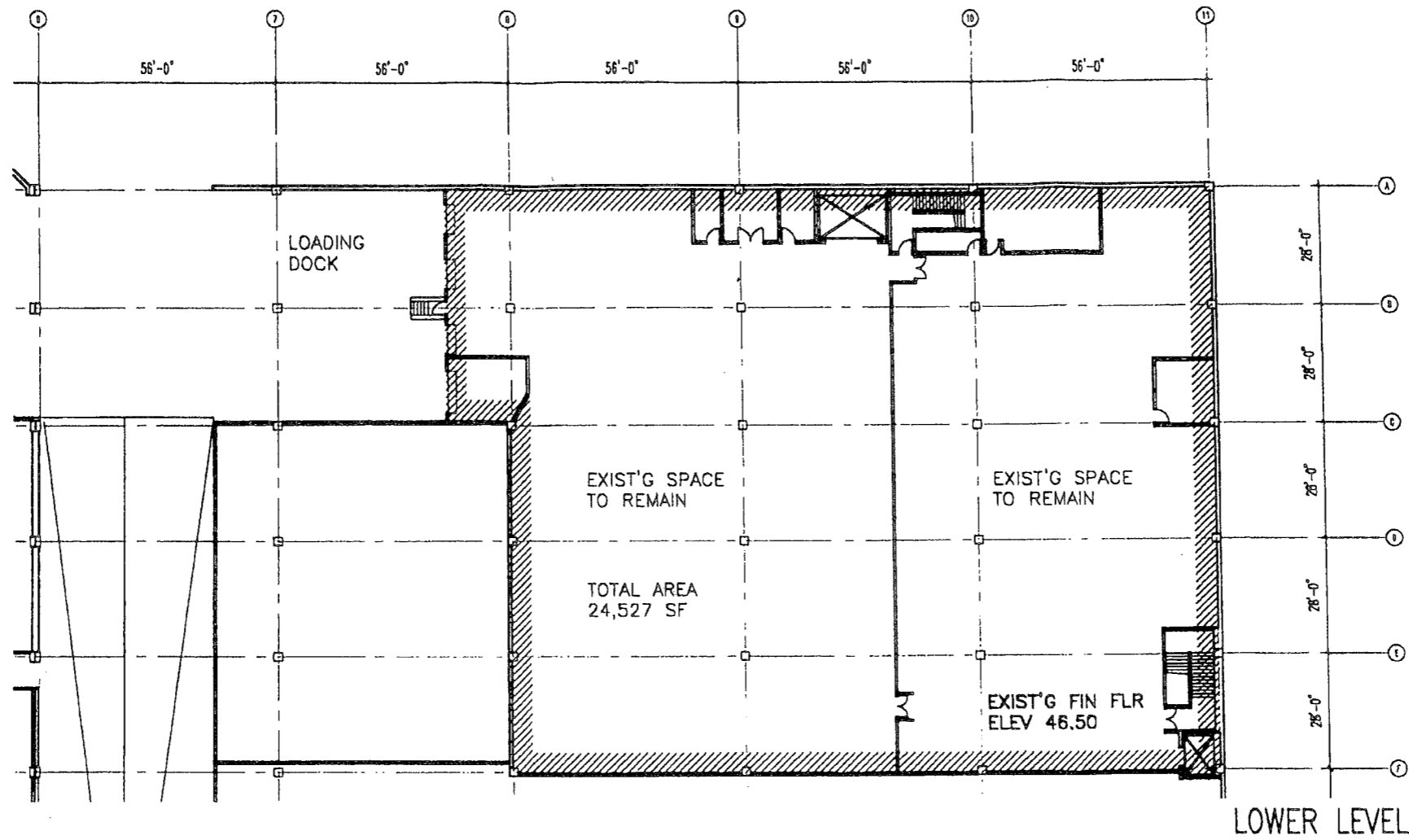

jem
 DEVELOPMENT COMPANY
 402 E YAKIMA AVENUE
 SUITE 1400
 YAKIMA, WA 98901
 (509) 249-4040

COPYRIGHT © 1998 BY JEM DEVELOPMENT COMPANY. ALL RIGHTS RESERVED. NO PART OF THIS DOCUMENT MAY BE REPRODUCED OR TRANSMITTED IN ANY FORM OR BY ANY MEANS, ELECTRONIC OR MECHANICAL, INCLUDING PHOTOCOPYING, AND RECORDING OR BY ANY INFORMATION STORAGE AND RETRIEVAL SYSTEM, WITHOUT PERMISSION IN WRITING BY JEM DEVELOPMENT COMPANY, INC.

RETAIL SPACE
 FOR
 YAKIMA, WA

DATE: APR 28, 2004
 JOB NO.
 SCALE: 1"=30'
 SHEET NUMBER:
 LL